



NEW

180 Watts,
24V Booster

ITP-800-8PH24

8x 10/100Base-TX with 8x PoE+ Ethernet Switch

The ITP-800-8PH24 is a non-managed Fast Ethernet PoE switches that provide 8x 10/100Base-TX Fast Ethernet with 8x high power PoE ports. The Ethernet switches is designed for industrial applications in harsh environments. The switches Ethernet ports utilize M12 connectors to ensure tight, robust connections and guarantee reliable operation against environmental disturbances such as vibration and shock. The ITP-500 (ITP-800) series Ethernet switches are compliant with EN 50155, covering operating temperature, power input voltage, surge, ESD, vibration, and shock, thus making these switches suitable for industrial applications in vehicle, rolling stock and railways.

Feature

- IP67 grade housing for against water, dust, and oil
- 8-Port 10/100Base-TX UTP with 8x IEEE802.3af/af PoE Ethernet Switch
- Use M12/M23 connector anti vibration and shock for vehicle, rolling stock, and railway applications
- 24/48VDC (20~57VDC) redundant dual input power with built-in very high efficiency (94~97%) to boost PoE output voltage to 55VDC
- Constant and regulated PoE output voltage at 55VDC
- Provides 8-port IEEE802.3af / 802.3at PoE output (30W per Port) ,Maximum PoE output power budget 180W
- Supports flow control
- DIN rail or wall mounting installation
- Supports broadcast storm protection
- Supports auto-negotiation and auto-MDI/MDI-X
- Wide operating temperature -40~75°C (ITP-500-E, ITP-800-E)
- CE, FCC, EN50155 and EN50121-4 for railway certified
- Industrial Grade EMS, EMI, EN61000-6-2, EN61000-6-4 certified

Specifications

IEEE Standard	IEEE 802.3 10Base-T Ethernet IEEE 802.3u 100Base-TX Fast Ethernet IEEE802.3x Flow Control and Back Pressure IEEE 802.3af PoE (Power over Ethernet) IEEE 802.3at PoE+ (Power over Ethernet enhancements)	Operating Temperature	-10°C~60°C (ITP-800-8PH24) -40°C~75°C (ITP-800-8PHE24)
Switch Architecture	Back-plane (Switching Fabric): 1.6Gbps	Operating Humidity	5% to 95% (Non-condensing)
Data Processing	Store and Forward	Storage Temperature	-40°C~85°C
Flow Control	IEEE 802.3x flow control, back pressure flow control	Housing	IP67 water-proof grade housing, and fanless
Provides Broadcast Storm Protection	Present	Dimensions	66.2 x 65.1 x 191.5 mm (D x W x H)
MAC Address Table	1 K	Weight	TBD
Packet Buffer Size	448Kbits	Installation Mounting	DIN rail or wall mounting
Network Connector	8x M12 D-code Female 10/100Base-TX auto negotiation speed Auto MDI/MDI-X function Full/Half duplex	MTBF	TBD (MIL-HDBK-217)
Network Cable	10Base-T: 2-pair UTP/STP Cat. 5e cable EIA/TIA-568 100-ohm (100m) 100Base-TX: 2-pair UTP/STP Cat. 5e cable EIA/TIA-568 100-ohm (100m)	Warranty	5 years
Protocols	CSMA/CD	Certification	
LED	Per unit: Power 1 (Green), Power 2 (Green) Per port: Link/Active (Green) PoE Port LED 1x LED /per Port : • PoE Output Power On : ON (Green) • PoE Output Power Off : Off (Green)	EMC	CE
Reverse Polarity Protection	Present for power input	EMI	FCC, FCC Part 15 Subpart B Class A CE EN 55022 Class A
Overload Current Protection	Present	Railway Traffic	EN50155, EN50121-4
Power Supply	Provide 1x M23 (5-Pin, male) for redundant dual DC 24/48V (20~57VDC) input power Built-in very high efficiency (94~97%) to boost PoE output voltage to 55VDC	Immunity for Heavy Industrial Environment	EN61000-6-2
Power Consumption	TBD	Emission for Heavy Industrial Environment	EN61000-6-4
		EMS (Electromagnetic Susceptibility) Protection Level	EN61000-4-2 (ESD) Level 3, Criteria B EN61000-4-3 (RS) Level 3, Criteria A EN61000-4-4 (Burst) Level 3, Criteria B EN61000-4-5 (Surge) Level 3, Criteria B EN61000-4-6 (CS) Level 3, Criteria A EN61000-4-8 (PFMF, Magnetic Field) Field Strength: 300A/m, Criteria A EN 61000-4-11 Voltage Dips EN 61000-4-12
		Safety	UL60950-1 (Pending)
		Shock	IEC 61373
		Freefall	IEC 60068-2-32
		Vibration	IEC 61373

ITP-800-8PH24

Specifications & Design are subject to change without prior notice. Please visit CTC Union website for more details.

Application

► Figure 1 : ITP Series in Railway Application

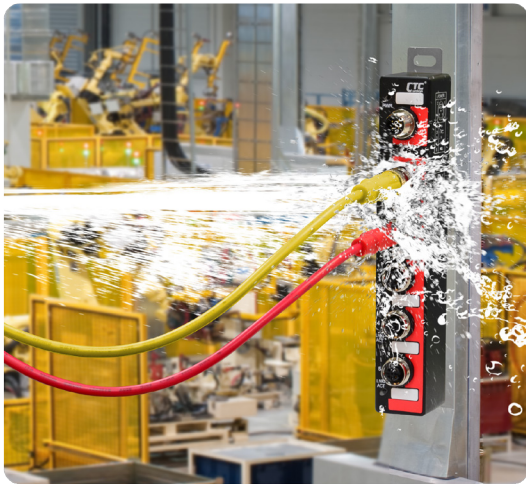
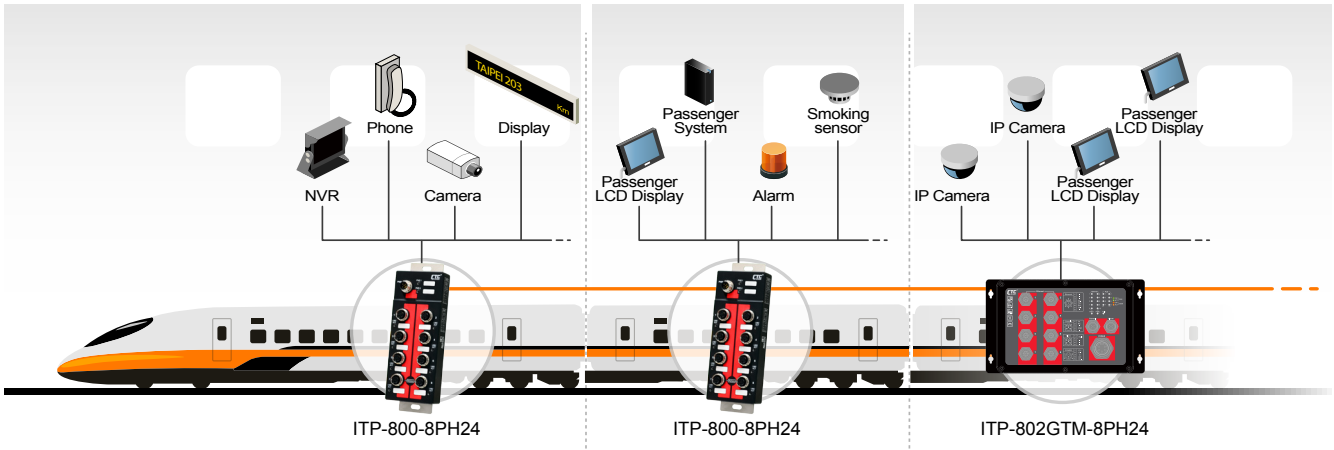

Figure 2 : IP67 Protection



Figure 3 : Wide Range Temperature

► Figure 4 : ITP Series for Industrial Automation



Figure 4 : ITP Series for Industrial Automation

Dimensions

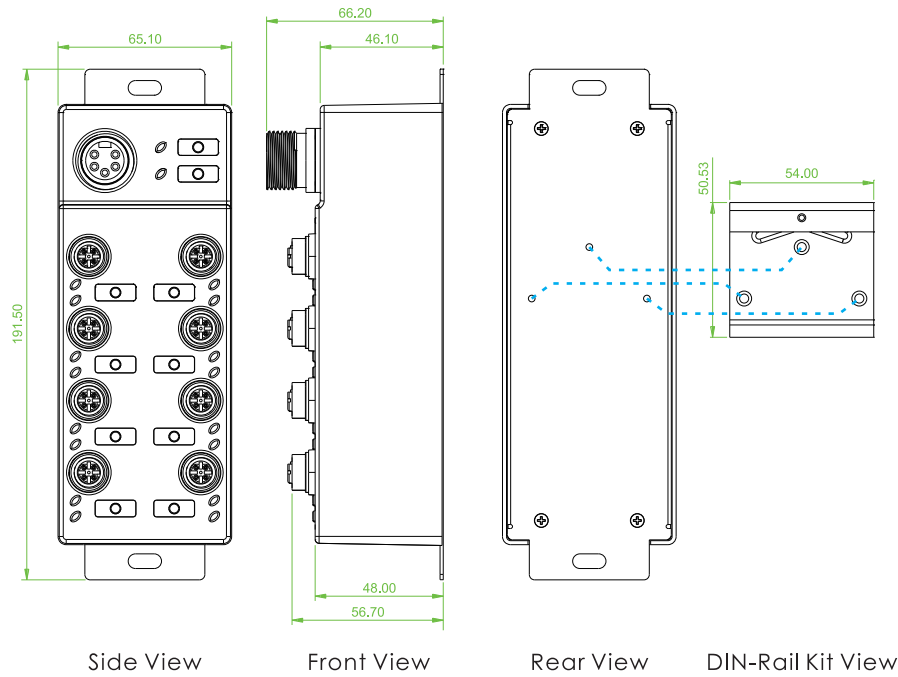

Ordering Information

Model Name	IP67	Total Port	UTP Port	PoE Port	PoE Total Power Budget	Input Voltage	Certification				Shock Vibration	Operating Temperature
			M12 10/100 Base-TX	IEEE802.3af			EN50155	EN50121-4	EN61000-6-2 EN61000-6-4	CE FCC		
ITP-800-8PH24	V	8	8	8	180W	V	V	V	V	V	V	-10~60 C
ITP-800-8PHE24	V	8	8	8	180W	V	V	V	V	V	V	-40~75 C

Model Naming Rule

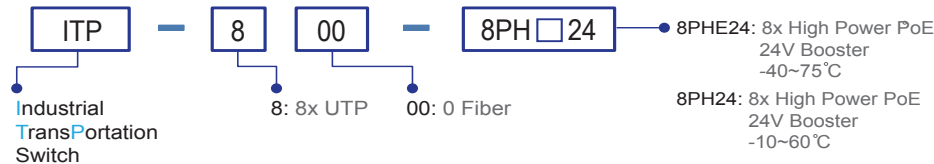

Optional Accessories

Power Supply

- DR-4524** Industrial Power, Input 85 ~ 264VAC, Output 24VDC, 48W, -10 ~ +50°C
- MDR-40-24** Industrial Power, Input 85 ~ 264VAC, Output 24VDC, 40W, -20 ~ +70°C

M12 Connector

IND-M12DM4-Connector
M12 D-code Male (4-Pin) connector, IP67



IND-M12AF5-Connector
M12 A-code Female (5-Pin) connector, IP67

