

B26

3MP Video Analytics Zoom Box with D/N, Extreme WDR, SLLS, 36x Zoom Lens



- 3 Megapixel
- Day & Night
- 36x Zoom Lens with f4.6 - 165.6 mm / F1.55 - 5.0, DC-Iris, Auto Focus
- Extreme WDR (145 dB)
- 30 fps at 2048 x 1536
- Built-in Analytics

PHOTO INDICATION

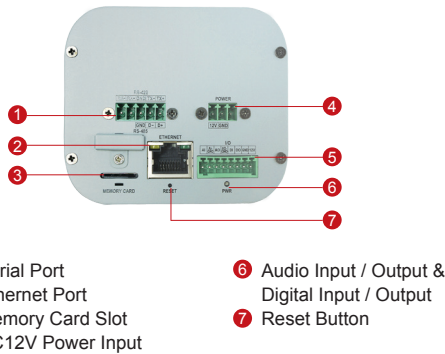

DIMENSION DIAGRAM

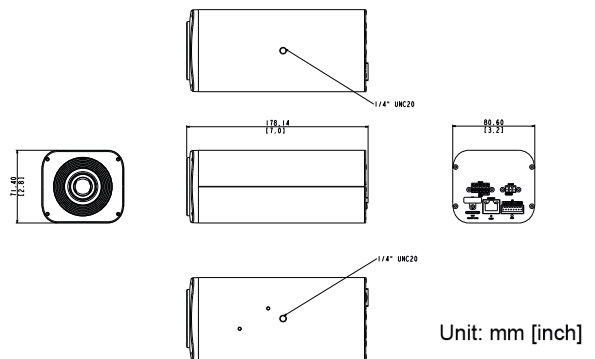

ACCESSORY OPTIONS

Power Supply		
PPOE-0001		IEEE 802.3af PoE Injector for Class 1, 2 or 3 devices, with universal adapter
PPBX-0011		Power Adapter, 100~240V, with universal connectors for all DC 12V powered devices

Popular Mounting Solutions		
PMAX-0203		Heavy Duty Outdoor Housing with Heater and Fan (230V) and Bracket
PMAX-0204		Heavy Duty Outdoor Housing with Heater and Fan (110V) and Bracket
PMAX-0205		Heavy Duty Outdoor Housing with Bracket
PMAX-0206		PoE Heavy Duty Outdoor Housing with Heater, Fan, Defogger and Bracket
Pole	PMAX-0203 PMAX-0508	
Corner	PMAX-0202 PMAX-1106 PMAX-0402	

* For more mounting solutions, please refer to Project Planner on www.acti.com

PRODUCT SPECIFICATION

• Device

Device Type	Zoom Box Camera
Image Sensor	Progressive Scan CMOS
Sensor Size	1/2.8"
Effective Pixels	2065 (H) x 1553 (V) (3.21 MP)
Horizontal Resolution	1450 TVL
Day / Night	Yes
Low Light Sensitivity	Superior
Minimum Illumination	Color: 0.1 lux at F1.55 (30 IRE, 2400°K); B/W: 0.05 lux at F1.55 (30 IRE, 2400°K)
Color to B/W Switch	ISP based switch; Configurable
Mechanical IR Cut Filter	Yes
IR Sensitivity Range	700 - 1100 nm
IR LED	No
Electronic Shutter	1/5 ~ 1/2,000 sec (manual mode) 1/5 ~ 1/120 sec (auto mode)
S/N Ratio	52 dB

• Lens

Focal Length / Aperture	Zoom, f4.6 ~ 165.6 mm / F1.55 ~ 5.0
Zoom Ratio /Speed	36x optical / 2 sec (wide to tele)
Zoom Application	Camera Installation, Auto Zoom by Event, Manual Operation
Iris	DC-Iris
Focus	Auto focus
Lens Mount	Board mount
Horizontal Viewing Angle	57.6° ~ 2.35°

• Video

Compression	H.265 H.264 (Baseline / Main / High profile) MJPEG
Max. Frame Rate vs. Resolution	30 fps at 2048 x 1536 60 fps at 1920 x 1080 30 fps at 1280 x 960 60 fps at 1280 x 720 30 fps at 800 x 600 30 fps at 640 x 480 30 fps at 320 x 240
Multi-Streaming	Simultaneous triple streams based on three configurations
Bit Rate	128 Kbps ~ 12 Mbps (per stream)
Bit Rate Mode	Constant, Variable
Privacy Mask	4 Configurable Regions
Image Enhancement	Extreme WDR (145 dB) White balance: automatic, hold, and manual Brightness Contrast Sharpness (auto) Auto Gain Control Digital Noise Reduction Flickerless Digital Image Stabilizer
Text Overlay	User defined text on video
Image Orientation	Image Flip, Mirror, Rotation
Built-in Analytics	Object Based Motion Detection, Tampering Detection, Shock Detection, Object Line Crossing Detection*, Object Enter Area Detection*, Missing Object Detection*, Unattended Object Detection*, Object Loitering Detection*, Smoke Detection*, Fire Detection* (*Some of the algorithms may not be available in the first release, can be upgraded for free later)

• Audio

Audio Type	2-way, Line-in, Line-out
Compression	8kHz, Mono, PCM, 16 bit encoding; G. 711

• Network

Protocol & Service	IPv4/v6, TCP, UDP, DHCP, PPPoE, HTTP, HTTPS, DNS, DDNS, NTP, RTP, RTSP, RTCP, SMTP, FTP, IGMP, ICMP, ARP, Bonjour, UPnP, QoS, SNMP, IEEE 802.1X
Ethernet Port	1, RJ-45 connector
Security	IP address filtering, HTTPS encryption, Password protected user levels, Anonymous login, IEEE 802.1X network access control

• Alarm

Alarm Trigger	Video Motion Detection (10 regions) External Device through Digital Input Sound Detection
Alarm Response	Notify control center, Change camera settings, Command other devices, E-mail notification with snapshots, Push notification to mobile device, Save video to local storage, Upload video or snapshot to FTP server, Upload video to NVR server, Activate external device through digital output

• Interface

Digital Input	1, Terminal block
Digital Output	1, Terminal block
Audio Input	1, Terminal block
Audio Output	1, Terminal block
Serial Port	1, RS-485/RS-422, Terminal block
Local Storage	MicroSDHC/MicroSDXC memory card slot (card not included)

• General

Power Source / Consumption	PoE Class 3 (IEEE802.3af) / 10.4 W DC 12V / 8.65 W
Weight	810 g (1.79 lb)
Dimensions (W x H x D)	71.4 mm x 80.6 mm x 178.14 mm (2.81" x 3.17" x 7.01")
Mount Type	Wall, Ceiling, Corner, Pole
Environmental Casing	Optional Housing (IP66 ~ IP68)
Starting Temperature	-10°C ~ 50°C (14°F ~ 122°F)
Operating Temperature	-30°C ~ 50°C (-22°F ~ 122°F)
Relative Humidity	10% ~ 85% RH
Heater Support	Yes
Approvals	CE (EN 55022 Class B, EN 55024), FCC (Part15 Subpart B Class B), UL (for optional PoE injector and power adapter)

• Integration

Unified Solution	Fully compatible with ACTi software
ISV Integration	Software Development Kit (SDK) available, ONVIF compliant (Profile S, Profile G)
Firmware Access Browser	Microsoft Internet Explorer 11.0
Auto Firmware Upgrade	Yes
GPS Position	Manual Setting